

# INSTALLATION INSTRUCTIONS

## HONEYCOMB/CELLULAR SHADES ON LARGE HEADRAIL



### Cordless Lift System Motorization

Thank you for your purchase. This shade has been custom built for you from the highest quality materials. To avoid errors and save valuable time, please read these instructions before installing your new shades.

### TOOLS YOU WILL NEED

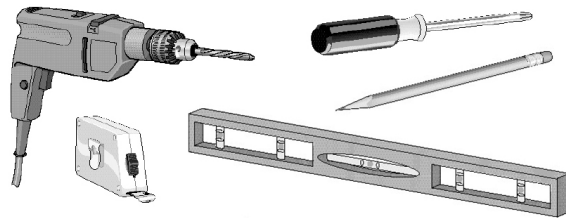
1. Pencil or Marker
2. Measuring Tape
3. Phillips Screwdriver
4. Carpenter's Level
5. Power Drill
6. Mounting Fasteners
7. 3/32" Drill Bit & 1/4" Hex Nut Driver Bit

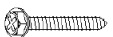

Mounting Surface	Fastener
Drywall, Plaster	Wall Anchors, Expansion Bolts (Not provided) 
Metal	Sheet Metal Screws (Not provided) 
Wood	No. 6 Hex Head Screws (Provided) 

### TABLE OF CONTENTS

Getting Started .....	Page 2
Mounting Type .....	Page 2
Bracket Installation .....	Page 2
Inside Mount .....	Page 3
Outside Mount .....	Page 3
Note on Motorization .....	Page 3
Installing the Shade .....	Page 4
Operating Cordless Lift Shade .....	Page 4
Adjusting the Shade .....	Page 4
Installing Cordless Handle .....	Page 5
Troubleshooting .....	Page 6
Care and Cleaning .....	Page 6
Child Safety .....	Page 7
Warranty Information .....	Page 7

## GETTING STARTED

Thank you for purchasing this Honeycomb Shade. All of the required installation components are wrapped in your package along with these instructions. With proper installation, operation, and care, your new shades will provide years of beauty and performance. Please thoroughly review this instruction booklet before beginning the installation. Check that the parts you have correspond to the parts shown below.

**Note:** Some parts may vary depending upon your chosen shade system or mounting option.

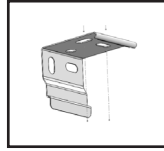

**Installation  
Brackets**

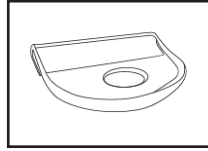

**Cordless Lift Handle**

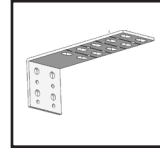

**Extension  
Bracket  
(optional)**

## Mounting Types

If the installation brackets are mounted correctly, the rest of the installation process will follow easily. To prepare for this important first step, review the mounting types and basic window terminology illustrated below.

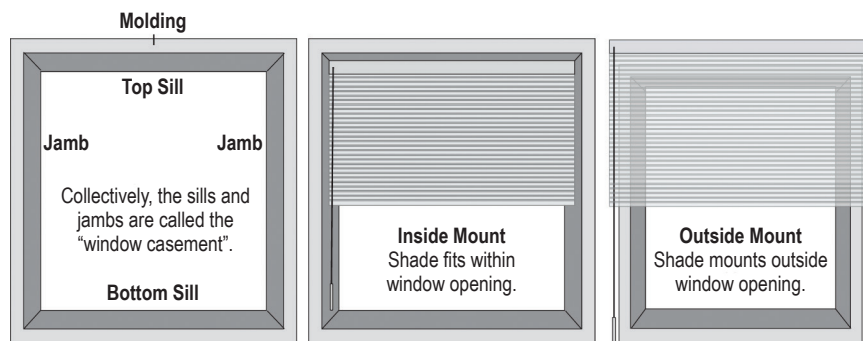

## Bracket Installation

The installation brackets may be for **INSIDE** or **OUTSIDE** mounts.

**Mounting the brackets level is essential for proper operation of the shade.** Shim the brackets if necessary to achieve a level alignment.

The bracket requirements and placements are the same for inside and outside mounts. Refer to the following spacing diagram and bracket requirement chart.

Shade Width	Brackets Required
Up to 36"	2
>36" - 72"	3
>72" - 90"	4
>90" - 120"	5
>120"	6

1-1/4" Pleat

Inside Mount	
Minimum mount depth	1-3/4"
Minimum mounting depth, flush mount	3"
Outside Mount	
Minimum flat vertical surface	1-1/2"

## NOTE ON MOTORIZATION

Prior to installing the shade, pair the motor with the remote using the instructions included with the remote.

### Inside Mount

For inside mounts the installation brackets will be screwed in place through the two top holes of each bracket.

Refer to the mounting depth chart below:

Minimum Depth	Fully Recessed
1-1/2"	3"

**NOTE:** Prior to mounting the brackets, add any clearance depth required to avoid obstructions such as window cranks or handles.

#### ATTACH THE BRACKETS

1. Screw installation brackets through top two holes to desired window sill location.
  - Use a 3/32" drill bit to drill holes for the screws.
2. Ensure all brackets are level and aligned.

**IMPORTANT:** If you are fastening the installation brackets to drywall, be sure to use wall anchors and follow the instructions provided with the anchors. (Anchors not provided.)

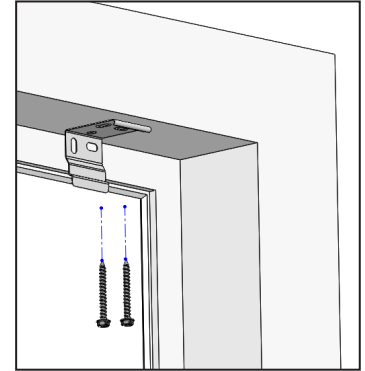

### Outside Mount

For outside mounts the installation brackets will be screwed in place through the two back holes of each bracket.

Refer to the minimum surface height chart below:

Minimum Height
1-1/2"

#### ATTACH THE BRACKETS

1. Screw installation brackets through top two holes to desired window sill location.
  - Use a 3/32" drill bit to drill holes for the screws.
2. Ensure all brackets are level and aligned.

**IMPORTANT:** If you are fastening the installation brackets to drywall, be sure to use wall anchors and follow the instructions provided with the anchors. (Anchors not provided.)

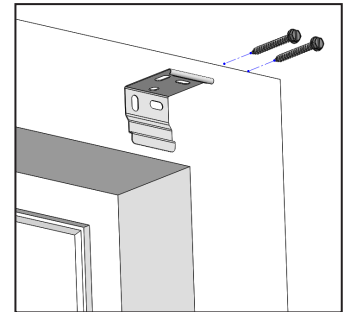

#### EXTENSION BRACKETS (OPTIONAL)

- Position the extension brackets to the desired wall location.
- The bracket tops must be aligned and level to one another.
- Mount the extension brackets through the back holes with two screws.
- Attach installation brackets to extension brackets with included screws & nuts.

**Note:** Use the same holes for all brackets to ensure even projection from the surface.

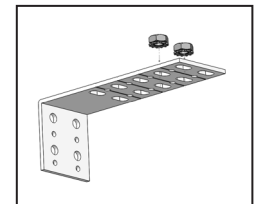

## Installing the Cordless Handle

### INSTALLING BOTTOM RAIL OPERATING HANDLE FOR BOTTOM-UP OR TOP-DOWN/BOTTOM-UP

**Note:** The cordless lift handle should be installed prior to mounting the shade in the window.

Shades over 42" in width will come with two handles per rail. If both handles are used they should be installed evenly across the rail.

- Locate the clear cordless bottom rail handle that arrived with your shade.
- Extend the shade, expanding the cells so they fully expose the bottom rail, allowing for an easier handle installation.
- Hook the lip of the handle over the top of the bottom rail.
- Once hooked under, pull the handle outward to ensure the handle has snapped into place.

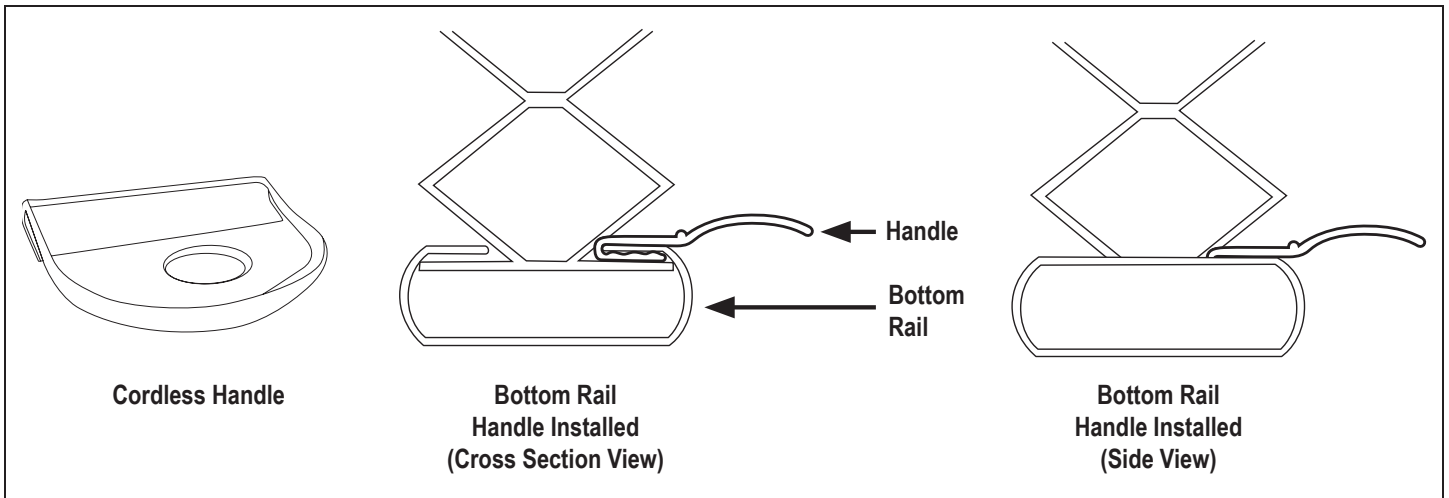

### INSTALLING MIDDLE RAIL OPERATING HANDLE FOR TOP-DOWN/BOTTOM-UP

**Note:** The cordless lift handle should be installed prior to mounting the shade in the window.

The middle rail handle is installed in an inverted position from the bottom rail handle.

- Locate the clear, cordless middle rail handle that arrived with your shade.
- Extend the shade, expanding the cells so they fully expose the middle rail, allowing for an easier handle installation.
- Hook the lip of the handle under the bottom of the middle rail.
- Once hooked under, pull the handle outward to ensure the handle has snapped into place.

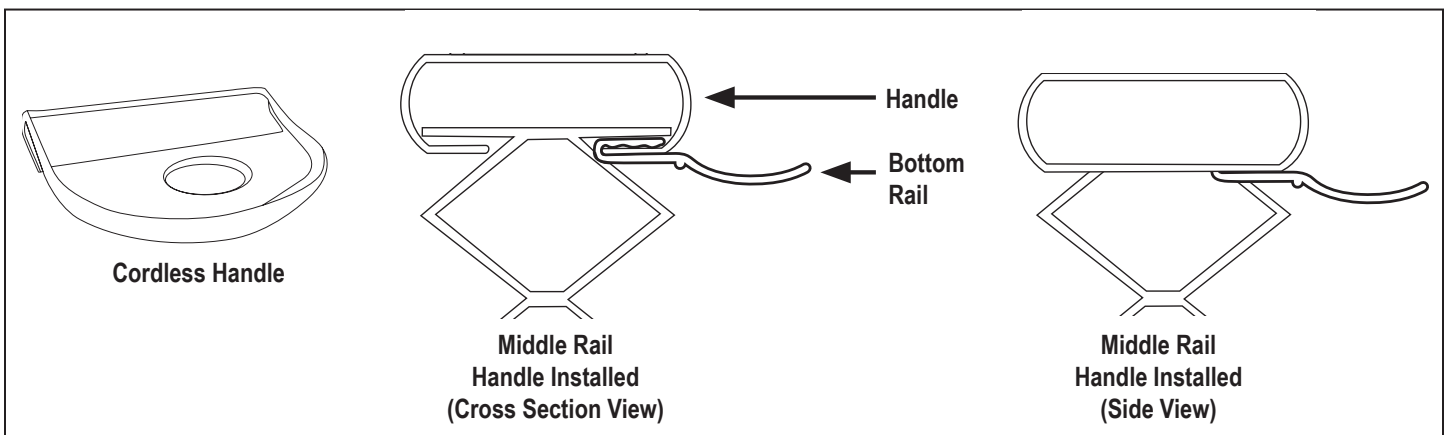

## Installing the Shade

### FOR CORDLESS LIFT SHADES (ONLY)

**Note:** The cordless lift handle should be installed prior to mounting the shade in the window.

### MOUNTING THE HEADRAIL

- With the front side of the shade facing you, tilt the headrail slightly backward to angle the front inside lip to the brackets.
- Rotate headrail back and upward to snap in it into place.

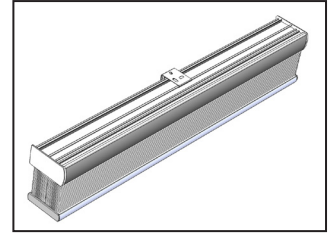

## Operating Cordless Lift Shade

### TO RAISE AND LOWER THE SHADE

- Hold the handle in the center portion of the bottomrail to ensure level movement.
- Shades over 42" in width will have 2 handles evenly positioned within hands reach along the center portion of the bottomrail to ensure level movement.
- Lower the shade by gently pulling downward to the desired position.
- Raise the shade by gently pushing upward to the desired position.

**Note:** Don't raise shade any higher than it was intended to go. If shade doesn't raise evenly, in most cases lowering it completely will allow cords to re-align on the spool.

## Adjusting the Shade

- Raise and lower the shade several times.
- If the length is incorrect or the bottom rail is not level, use the following steps to correct.

### BOTTOMRAIL SHADE ADJUSTMENT

- Lift bottomrail on the side to be adjusted. This will take the weight off the cord.
- Use a screwdriver or dime.
  - Turn screw clockwise to lift that side of the shade.
  - Turn screw counter clockwise to lower that side of the shade.
  - Half a revolution is 1/4" adjustment (maximum adjustment is 1/2").

### INTERMEDIATE RAIL SHADE ADJUSTMENT

- Lift intermediate rail on side to be adjusted. This will take the weight off the cord.
- Use a screwdriver or dime.
  - Turn screw clockwise to lift that side of the rail.
  - Turn screw counter clockwise to lower that side of the rail.
  - Half a revolution is 1/4" adjustment (maximum adjustment is 1/2").

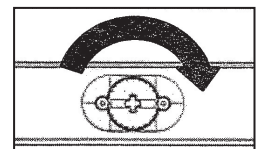

Lift Shade Side

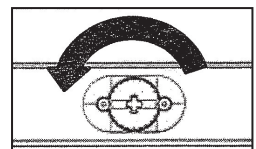

Lower Shade Side

## TROUBLESHOOTING

### THE SHADE WILL NOT SNAP INTO THE INSTALLATION BRACKETS.

- Check that the installation brackets are aligned and level.

### THE SHADE IS HARD TO RAISE OR LOWER, OR WILL NOT RAISE OR LOWER.

- Shades cannot be forced into tight inside mount window openings. If an inside mount, check that the shade is installed correctly. Make sure there is clearance between the ends of the shade and the window casement.
- Check that the installation brackets are level. Shim to level, if necessary.
- If hold-down brackets are used, make sure they have been released.
- Make sure the fabric is not caught.

### THE SHADE RAISES OR LOWERS UNEVENLY OR THE BOTTOM RAIL IS UNEVEN.

- Check that the window is square by measuring the diagonals.
- Check that the installation brackets are level. Shim to level, if necessary.
- Adjust the cords under the bottom rail (see “Adjusting The Shade” on page 4).

### IMPORTANT INFORMATION REGARDING CORDLESS SHADE OPERATION.

- Daily operation of shade will ensure that it performs at its optimal level.
- If the shade is in the lowered position for an extended period of time, extra care needs to be taken when raising the shade. The fabric will relax and may resist lifting. This is a natural occurrence with all fabric shades. When lifting, you may notice the billowing (falling out) toward you. This is temporary and can be corrected by slowly raising the shade completely and then operating several times. This allows the fabric to go back to its pleated state, and the shade will operate as designed.
- If shade has been in the fully raised position for an extended period of time, it may have a tendency to “spring back” above the desired length of the shade. This is temporary and can be corrected by completely raising the shade and operating several times.
- Operating the shade with the handle(s) provided is recommended so that the shade is balanced when raising and lowering.

## CARE AND CLEANING

Honeycomb shades are made of an anti-static, dust resistant fabric which repels dirt and dust. For most of these fabrics, the following options are available if your shade needs cleaning.

**DUSTING:** Regular light dusting with a feather duster is all the cleaning that is needed in most circumstances.

**VACUUMING:** Use a hand-held vacuum with low suction for more thorough dust removal.

**SPOT CLEANING:** Use the following steps for spot cleaning: (1) Prepare a solution of warm water and mild dish-washing detergent. (2) Dampen a clean cloth in the solution and ring it out. (3) Dab the spot with the dampened cloth until it is gone. **DO NOT RUB THE FABRIC.** (4) Allow the shade to dry in the completely lowered position.

**CAUTION:** *Avoid creasing Blackout fabrics during cleaning.*

**DEEP CLEANING:** Use the following steps for deep cleaning: (1) Immerse shade in basin or bathtub filled with warm water and mild detergent. (2) Rinse with clean water. (3) Fully raise shade and tilt to eliminate excess water, (4) Reinstall damp shade, lower it, and let it dry completely.

**CAUTION:** *Do not immerse Blackout fabrics. Do not immerse the headrail.*

**ULTRASONIC CLEANING:** Standard shades, except those made with Blackout Lining can be ultrasonically cleaned by a professional.

- Specify that a mild detergent be used.
- Never immerse the headrail.
- Dry the shade completely in the lowered position.

**CAUTION:** *Do not ultrasonically clean Blackout fabrics. Do not immerse headrail.*

## QUICK PROGRAMMING GUIDE

## POWERWAND™

Honeycomb Shades | Dual Shades | Roller Shades  
Sheer Shadings | Natural Woven Shades

### 1a. Attach the Wand — Sheer Shadings, Dual & Roller Shades

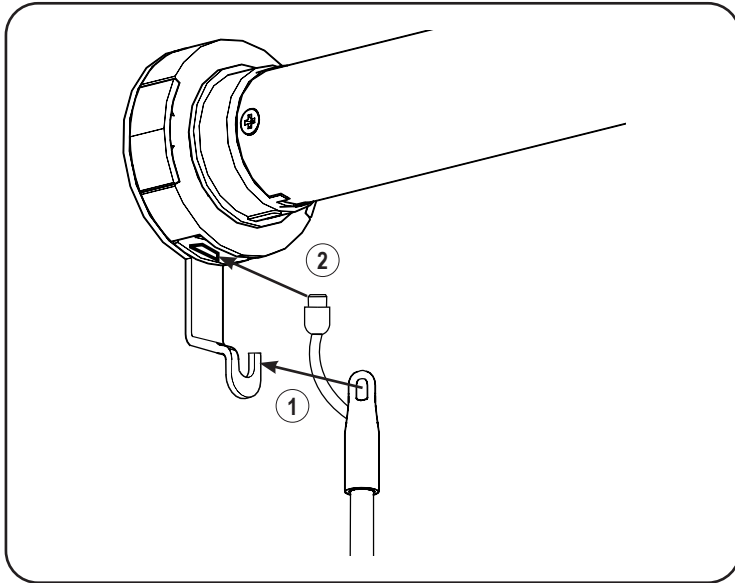

On Dual Shades, Roller Shades and Sheer Shadings, with the wand control buttons facing you, attached the top of the wand on the metal hook support (1) on the motor control side, then connect the cable into the motor head (2).

**Note:** On Sheer Shadings ordered with Powerwand on the right side, the cable may be wrapped around the hook. This is normal. You may unwrap, if you desire, as this does not affect functionality. You still need to connect the cable into the motor head.

### 1b. Attach the Wand — Honeycomb Shades

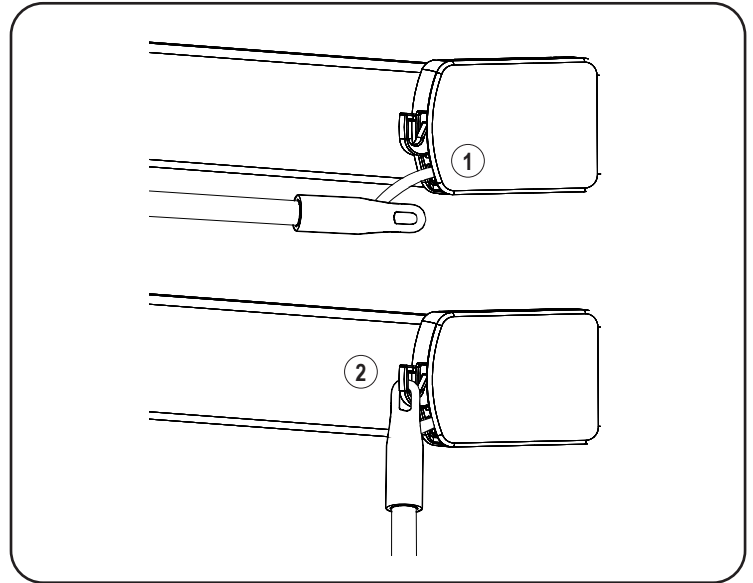

On Honeycomb shades, the wand will be already connected to the shade (1). With the wand control buttons facing you, attached the top of the wand into the plastic hook support on the motor control side (2).

### 1c. Attach the Wand — Natural Woven Shades

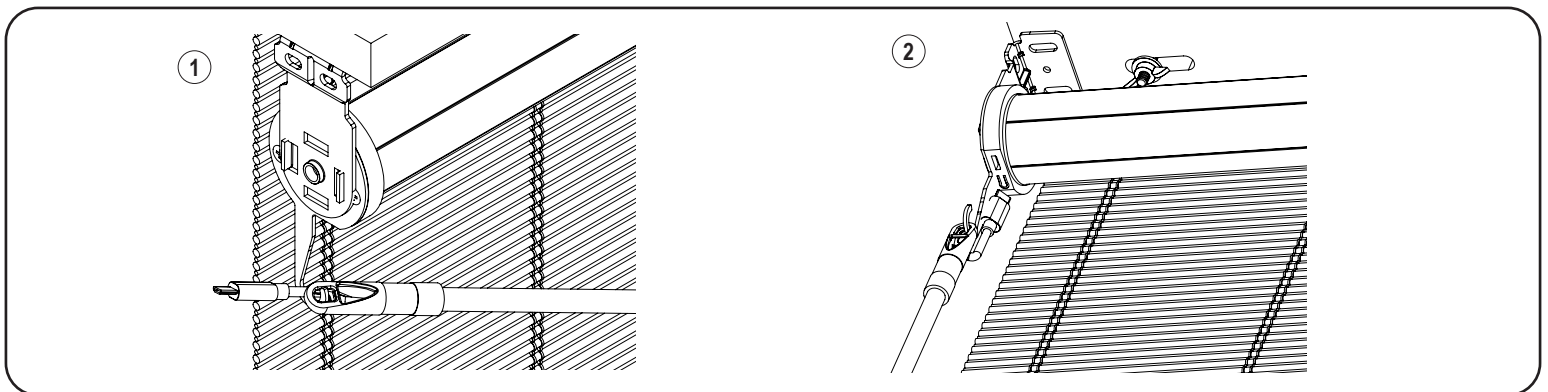

On Natural Woven Shades, with the wand control buttons facing you (1) approach the hook with the wand parallel to the headrail. (2) Gently twist the wand to attach it to the hook. Connect the cable into the motor.

**Important:** Before starting the programing, install the shade following the installation instructions provided.  
Honeycomb shades are shipped with the motor in sleep mode to avoid activation during transit.

**For Honeycomb Shades,** To wake up the motor prior to operating the shade: Press the STOP button 5 times (1) - the first 4 times press quickly and the 5th time PRESS and HOLD the stop button until the motor jog (2).

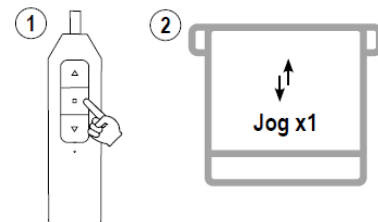

## QUICK PROGRAMMING GUIDE

### 2. Operate the Wand

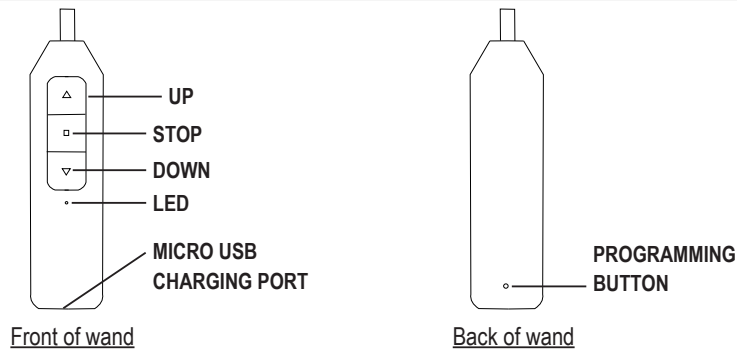

#### Roller and Honeycomb Mode:

- Press the **DOWN** or **UP** button to lower or raise the shade. Press the **STOP** to stop the shade at the desired position.

#### Sheer Shadings and Dual Shades Mode:

- Tapping the **UP** or **DOWN** button for less than 2 seconds will move the shade in short steps.
- Holding the **UP** or **DOWN** button down for more than 2 seconds before releasing will operate the shade at the standard speed.
- Press the **STOP** button to stop the shade at the desired position.

### 3. Set a Favorite Position

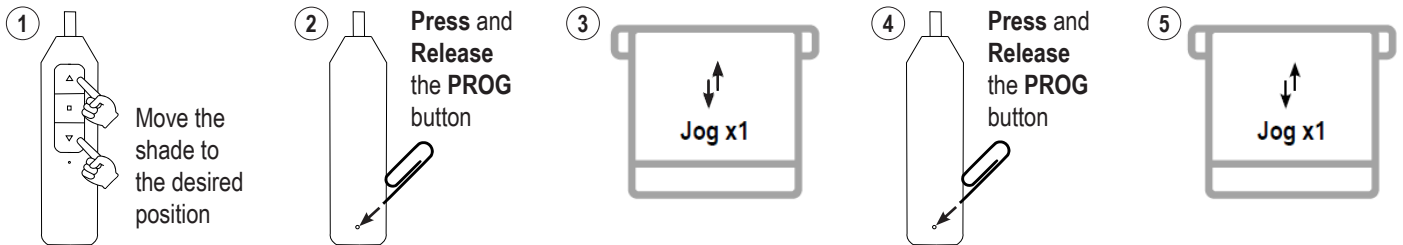

**IMPORTANT:** Once the favorite position is set, the shade will always stop at the designed favorite position when passing by it.  
Click 2 x Up or Down button, the shade will go to set Top or Bottom Limit.

### 4. Remove a Favorite Position

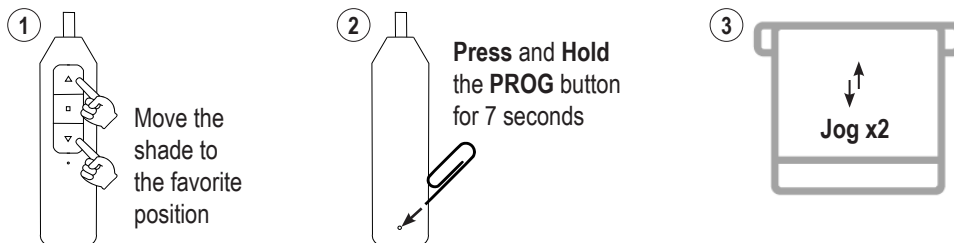

### 5. Advanced Programming

**IMPORTANT:** Damage to shade may occur when operating the motor prior to setting limits. Attention should be given.

#### Switch between Roller and Sheer Shadings Mode

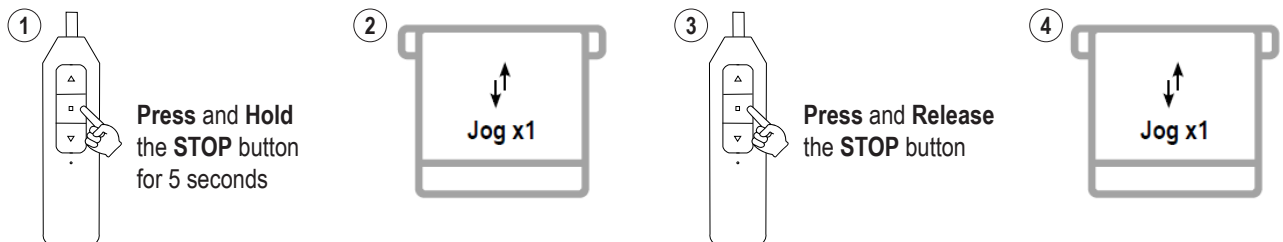



## QUICK PROGRAMMING GUIDE

### Adjust the Top and/or Bottom Limit

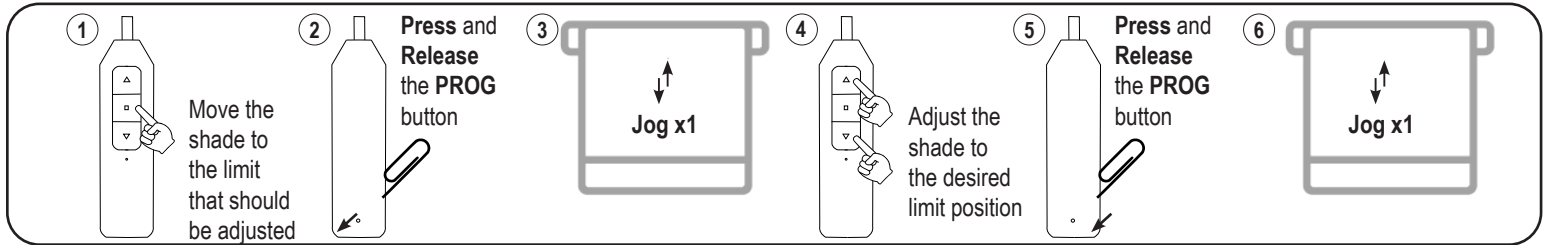

### Factory Motor Reset

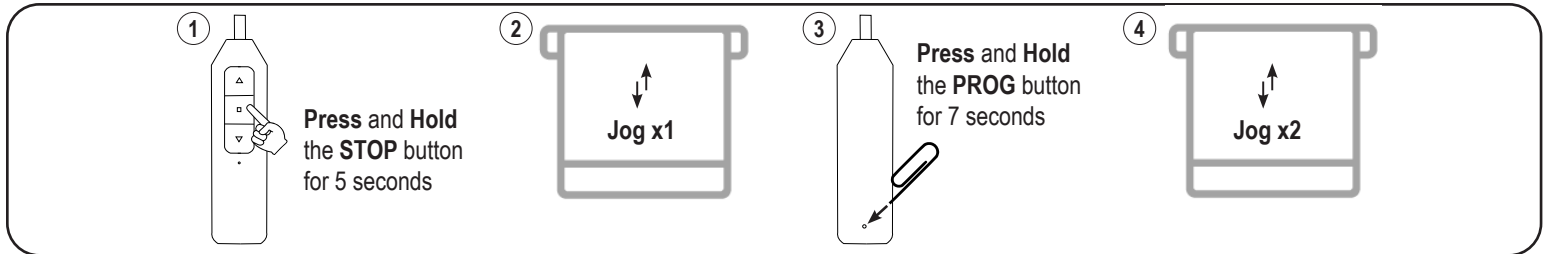

**IMPORTANT:** All limits will be erased. The motor direction will return to default and may need to be adjusted.

### Reverse UP and DOWN Commands (Only if necessary)

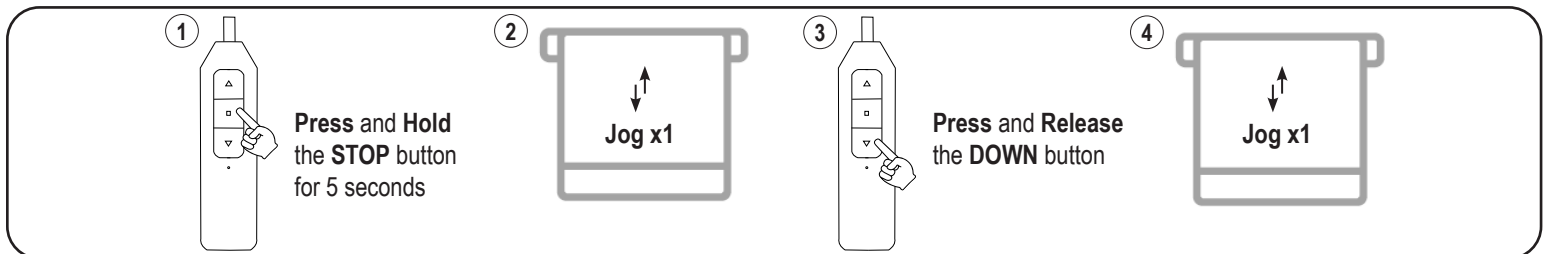

### Set Upper and Lower Limits ( Only after Factory Motor Reset)

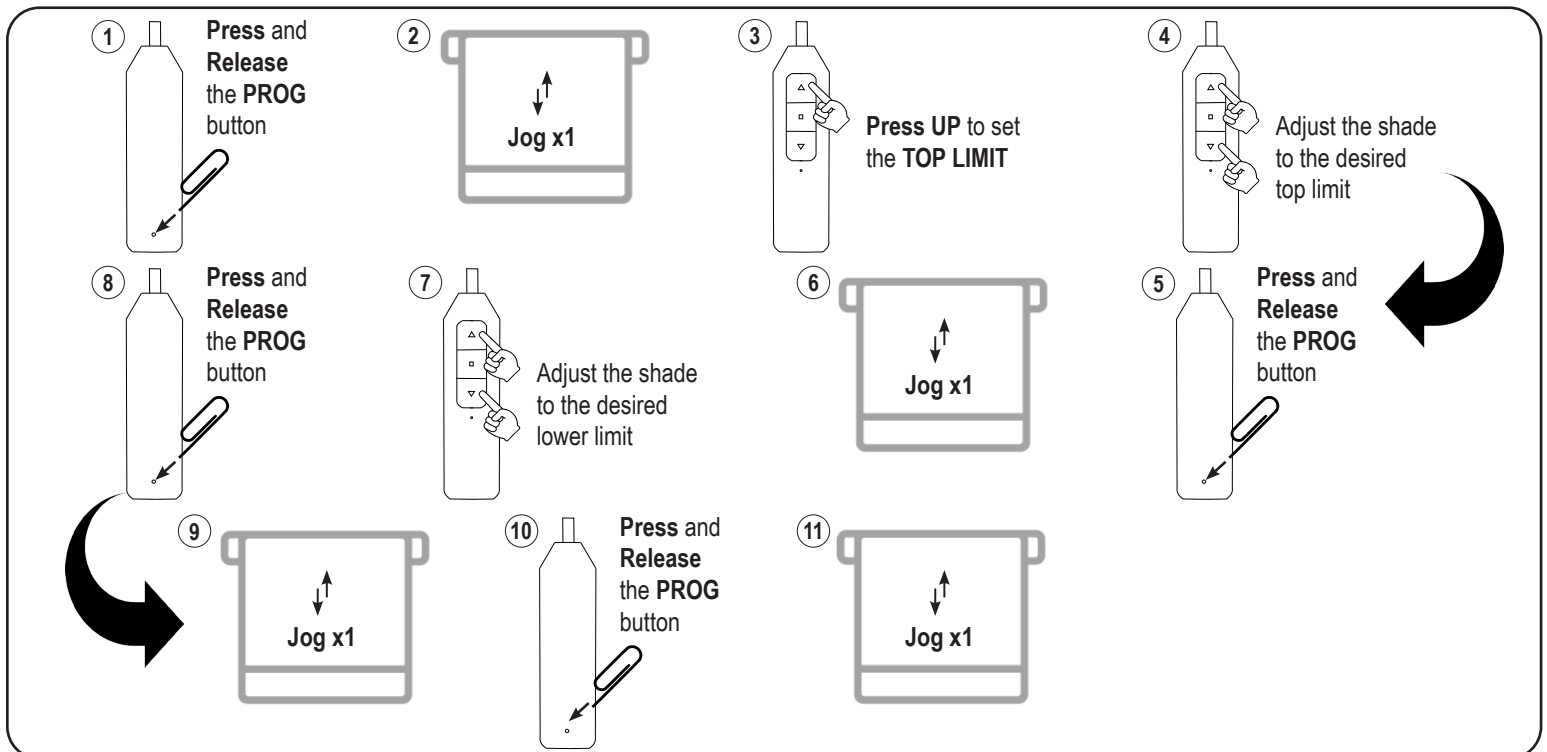

## 6. Charge the Battery

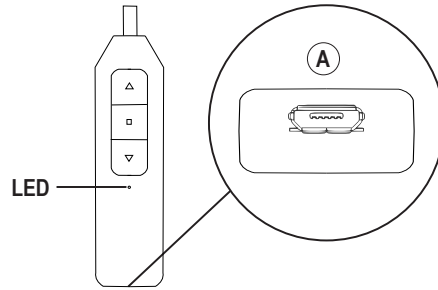

When the shade begins to operate slower than normal or only beeps when you attempt to operate, it is time to charge the battery.

To Charge, connect a standard micro USB cable into the bottom of the wand **(A)** and into USB 5V/2A (max) power supply. A red LED on the wand indicates that the battery is charging. To fully charge the batteries, allow the batteries to charge for at least 1 hour after the LED on the wand turns green.

**Note:** A typical charge cycle can take between 4-6 hours.

## Troubleshooting

Issues	Possible Causes	Solution
The shade is not responding	Built in battery is depleted	Recharge with compatible USB 5V/2A (max) adapter and a micro USB cable. Details under "6. Charge the Battery"
	Wand is not fully connected to the motor	Check the connection between the wand and the motor
The shade moves the opposite direction on the control buttons	The motor direction is reversed	See details under "Reverse Up and Down Commands"
The shade stops by itself before it reaches the top or bottom limit	A favorite position was set	See details under "4. Remove a Favorite Position"
The shade only moves in small steps after pressing the button	The shade is operating on Sheer Shadings/ Dual Shades mode	Switch to Roller/Honeycomb mode by following the steps under "Switch between Roller and Sheer Shadings Mode"
	The shade has no limit set	See details under "Set Upper and Lower Limits"

## Child Safety

**⚠ WARNING/ADVERTENCIA**
5.1.3 Rev. 5/18 Print 5/18

Window Blind Cord Can **STRANGLE** Your Child. To prevent strangulation, purchase cordless products or products with inaccessible cords.

La cuerda de la persiana puede **ESTRANGULAR** a su niño. Para evitar el estrangulamiento, compre alternativas cuerda o productos con cuerdas inaccesibles.



1035121